

09-OCT-2025 12:30
S:\Server_Files\PROJECTS\2018\A2018308.00_NV5_Div 14 Bridges (3)\A2018308.25_CALYX_Div 14 B-5896\Design\Utilities\Engineering\UB0\Proj\B-5896_ut_tsh_U01_psh.dgn
\$\$\$\$\$USERNAME\$\$\$\$\$

TIP PROJECT: BP14.R006

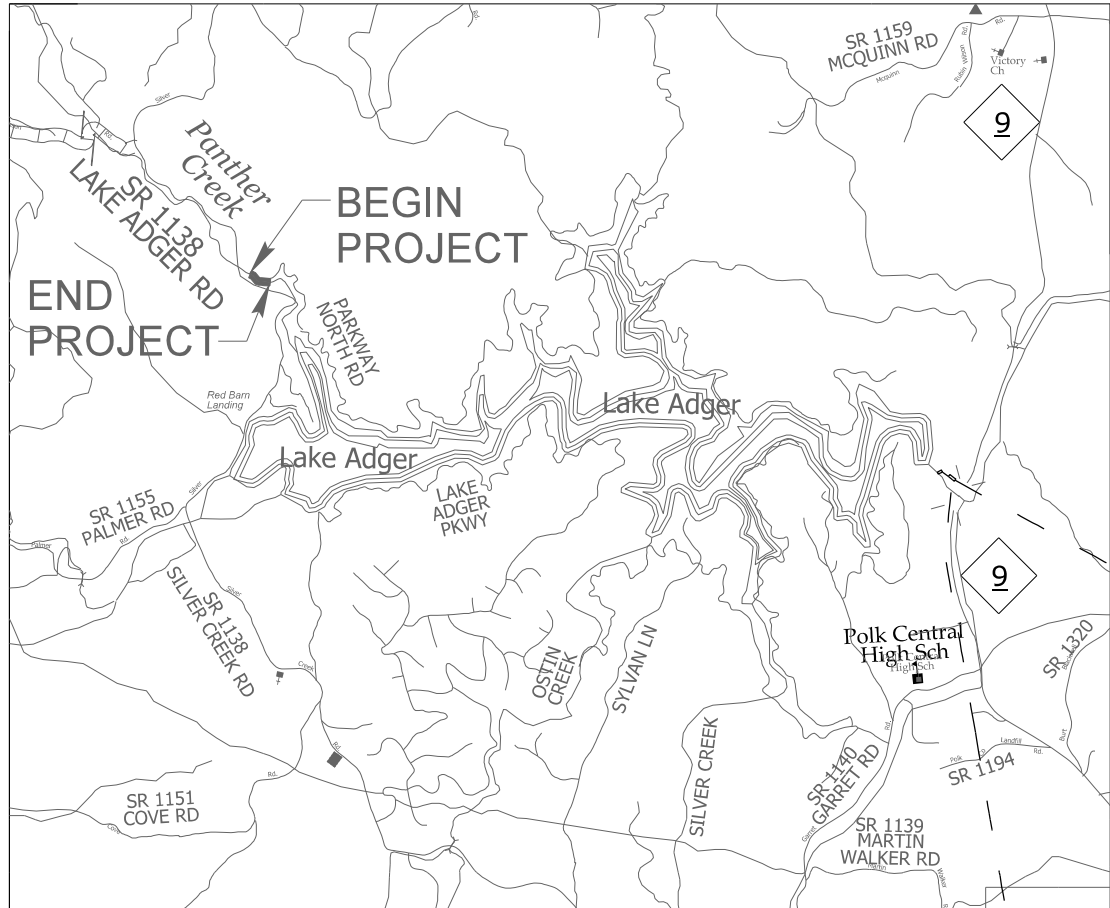

VICINITY MAP

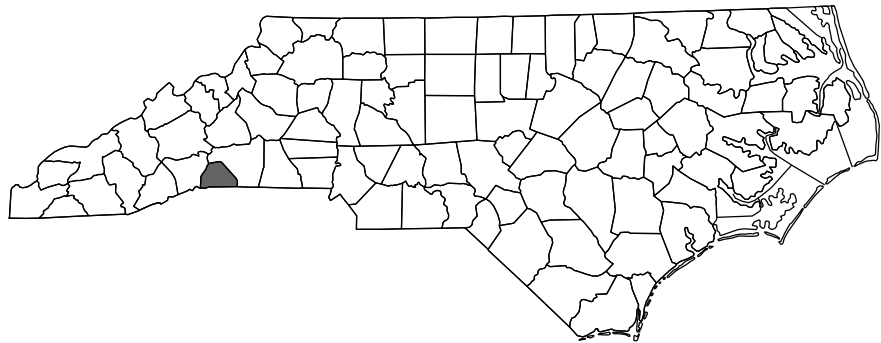

STATE OF NORTH CAROLINA
DIVISION OF HIGHWAYS

UTILITIES BY OTHERS PLANS
POLK COUNTY

LOCATION: BRIDGE #740043, SR 1138 (LAKE ADGER RD) OVER PANTHER CREEK
TYPE OF WORK: POWER DISTRIBUTION & TELECOM RELOCATIONS

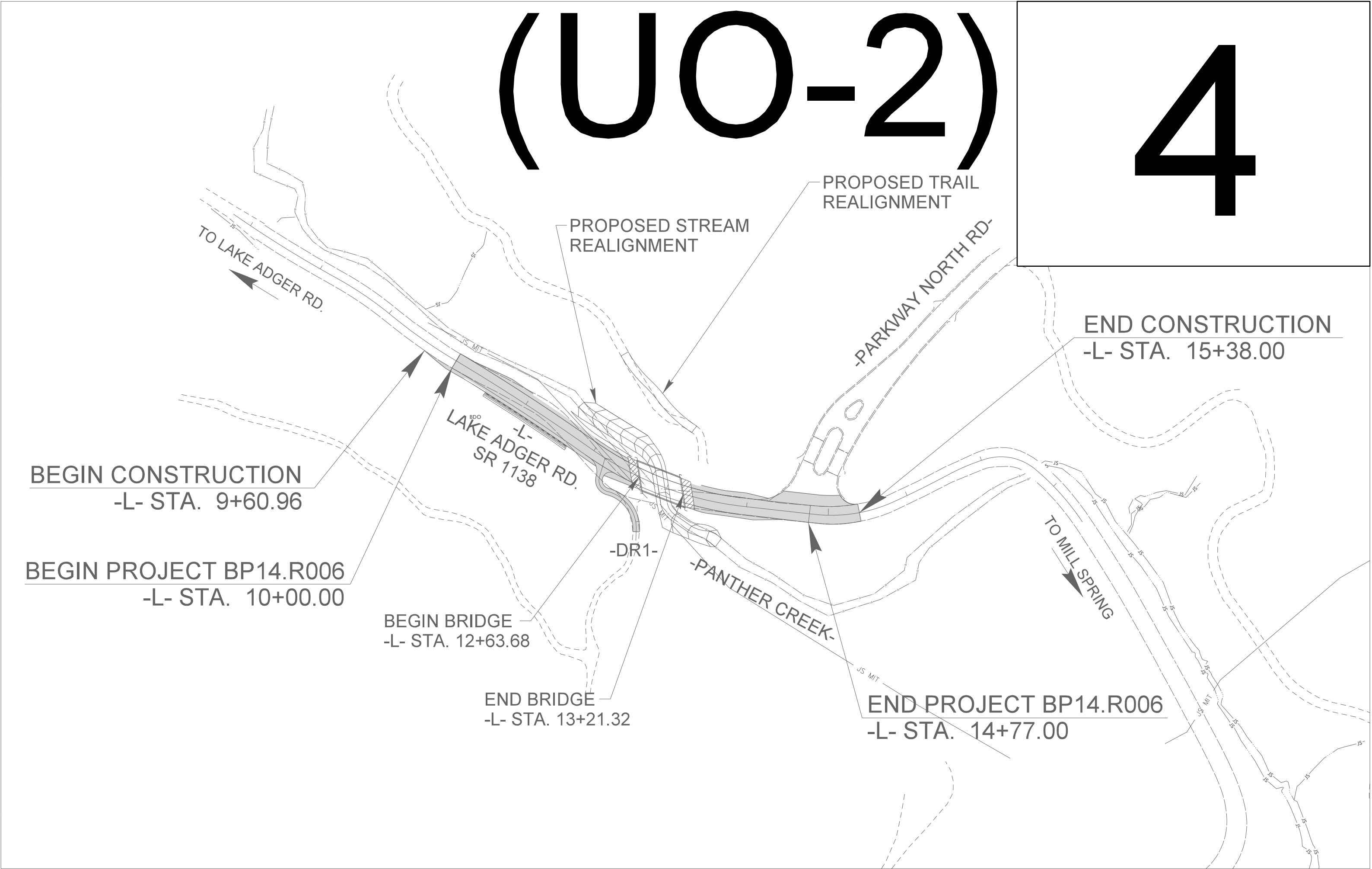

NAD 83NA 2011

THERE IS NO CONTROL OF ACCESS ON THIS PROJECT

GRAPHIC SCALES

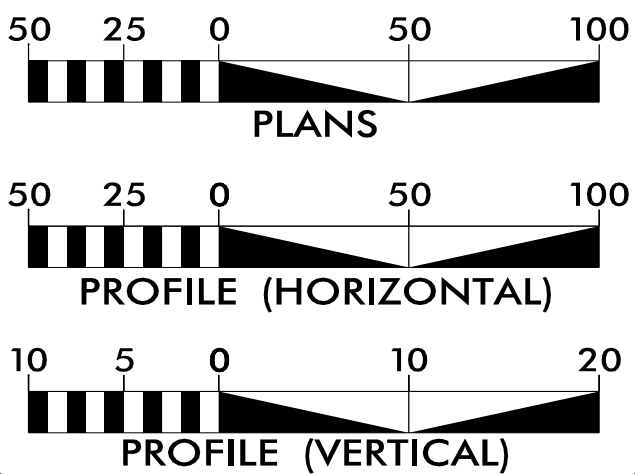

INDEX OF SHEETS

SHEET NO.	DESCRIPTION
UO-1	TITLE SHEET
UO-2	UBO PLAN SHEET

UTILITY OWNERS WITH CONFLICTS

- (A) POWER DISTRIBUTION - REMC
(B) TELECOM - AT&T

PREPARED IN THE OFFICE OF:



Clint L. Stevens, PE	UTILITY COORDINATION PROJECT MANAGER
Kevin S. Hinde, PE	PROJECT UTILITY COORDINATOR
James N. Arnold	PROJECT UTILITY DESIGNER



DIVISION OF HIGHWAYS
DIVISION 14

253 WEBSTER RD.
SYLVA, NC 28779
PHONE (828) 586-2141
FAX (828) 586-4043

Robert Golding	DIVISION UTILITY ENGINEER
Lynn Kieselhorst	DIVISION UTILITY COORDINATOR
Zack Schuler	DIVISION BRIDGE PROGRAM MANAGER